

Data sheet 100B47.5-56

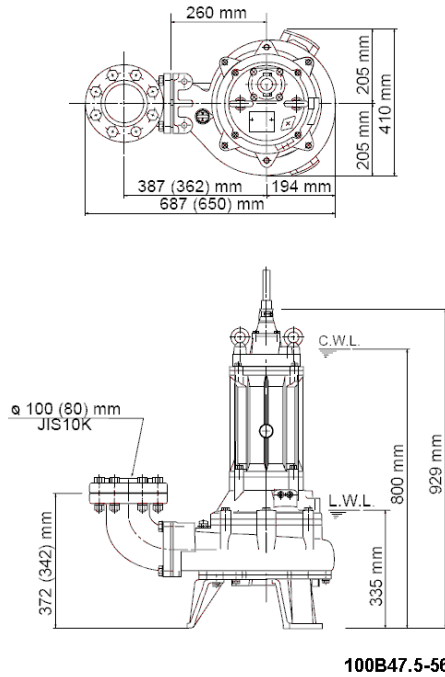

100B47.5-56

CWL: Continuous running water level
LWL: Lowest running water level

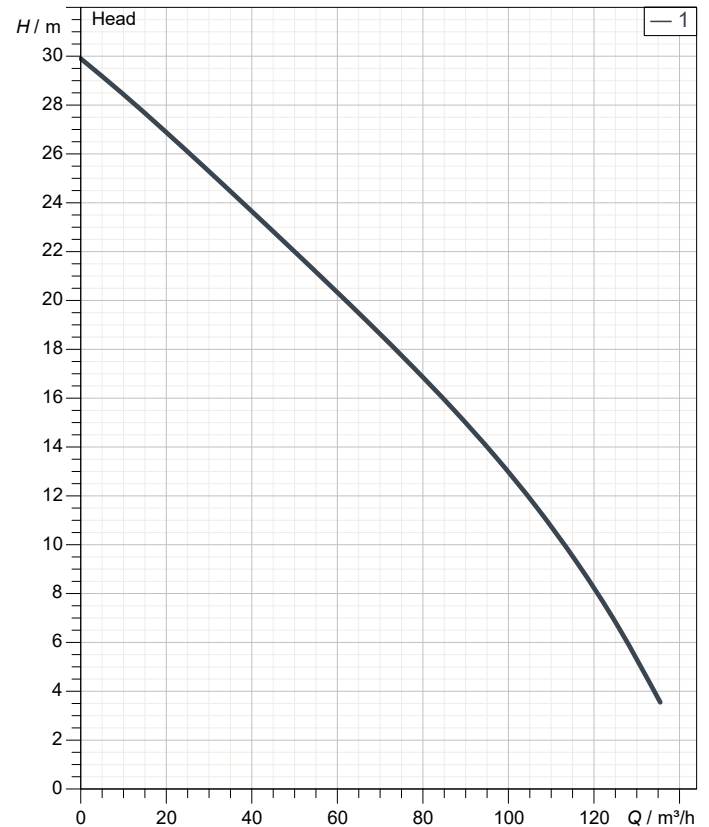

Specification

Electric submersible pump B-series
Degree of protection IP 68
Pressure resistance max. 15 m
Type of impeller dual channel impeller
Free passage 40 mm
Suitable for:
sewage water

Electric motor

Dry-type submersible induction motor
Insulation class F 4Poles 1455 1/min
Starting mode Direct starting
Rated voltage 400 V 50 Hz 3~
Power uptake 9.16 kW
Rated power 7.50 kW
Rated current 15.9 A
Start current 89.0 A

Cable

10m NSSHÖU 4Cx2,5mm²

Motor Protection

Circle thermal protector
(snap-action bi-metal device)

Shaft seal

Double inside mechanical seal in oil bath
additional lubrication by oil lifting device
Primary seal
Silicon carbide on silicon carbide
Secondary seal
Silicon carbide on silicon carbide

Bearings

Shielded ball bearings, maintenance-free

Materials

Impeller
FC200 (EN-GJL-200)
Pump casing
FC200 (EN-GJL-200)
Suction cover
FC200 (EN-GJL-200)
Motor Frame
FC200 (EN-GJL-200)
Shaft
DIN 1.4000 (EN-X6Cr13)

Discharge size

4" (100mm) JIS 10K screwed-in mating flange
guide rail fitting optional

Weight

169 kg (dry weight of the pump only without cable)

Performance curve

100B47.5-56

Discharge port	4"
Head	29.9 m
Flow	135.5 m ³ /h
Rated power	7.50 kW
Power input	9.16 kW
Phases	3~
Voltages	400 V
Frequency	50 Hz
Rated current	15.9 A
Starting current	89.04 A
Number of poles	4
Speed	1455 1/min
Starting mode	Direct starting
Insulation class	F

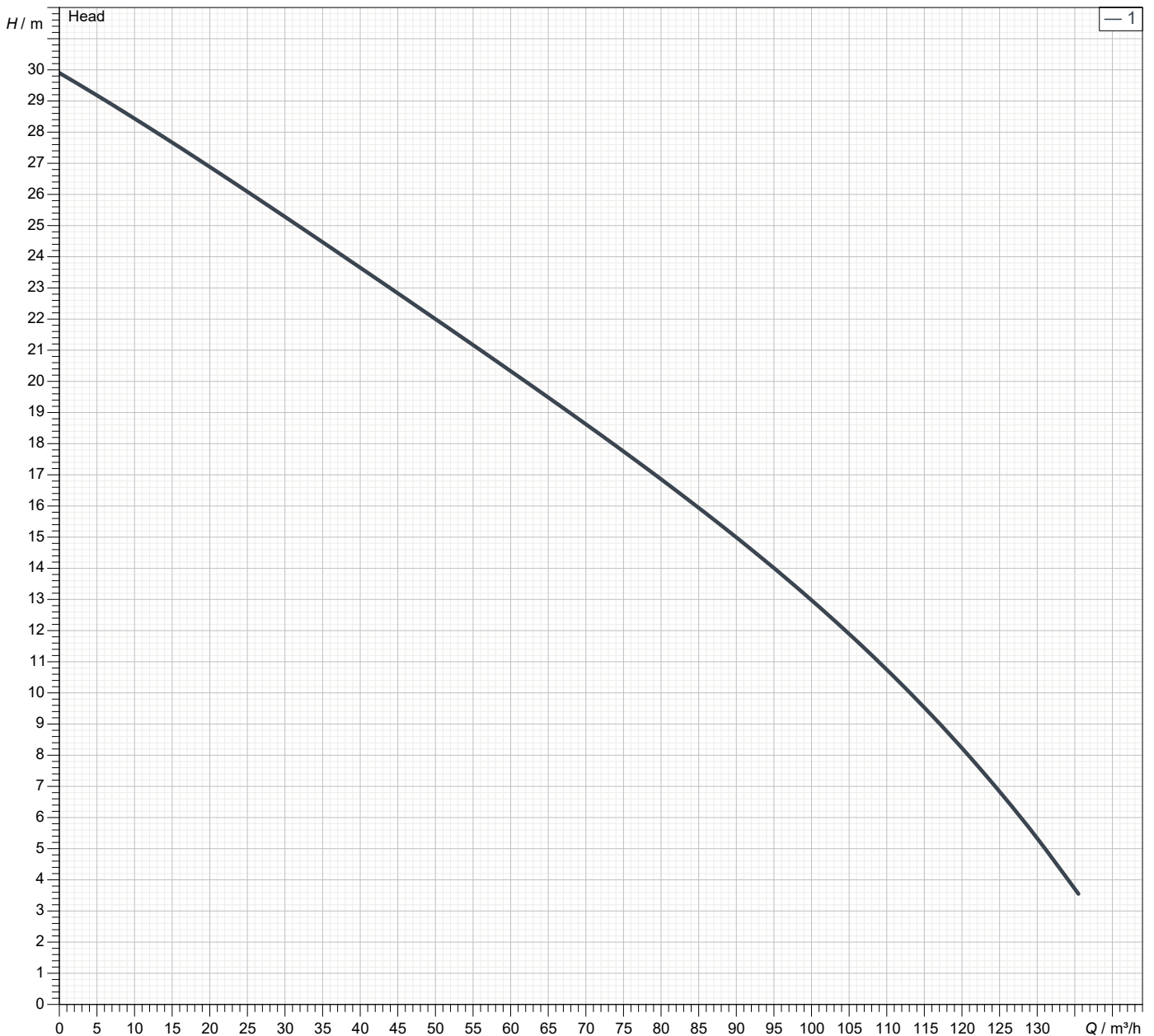

Dimensions

100B47.5-56

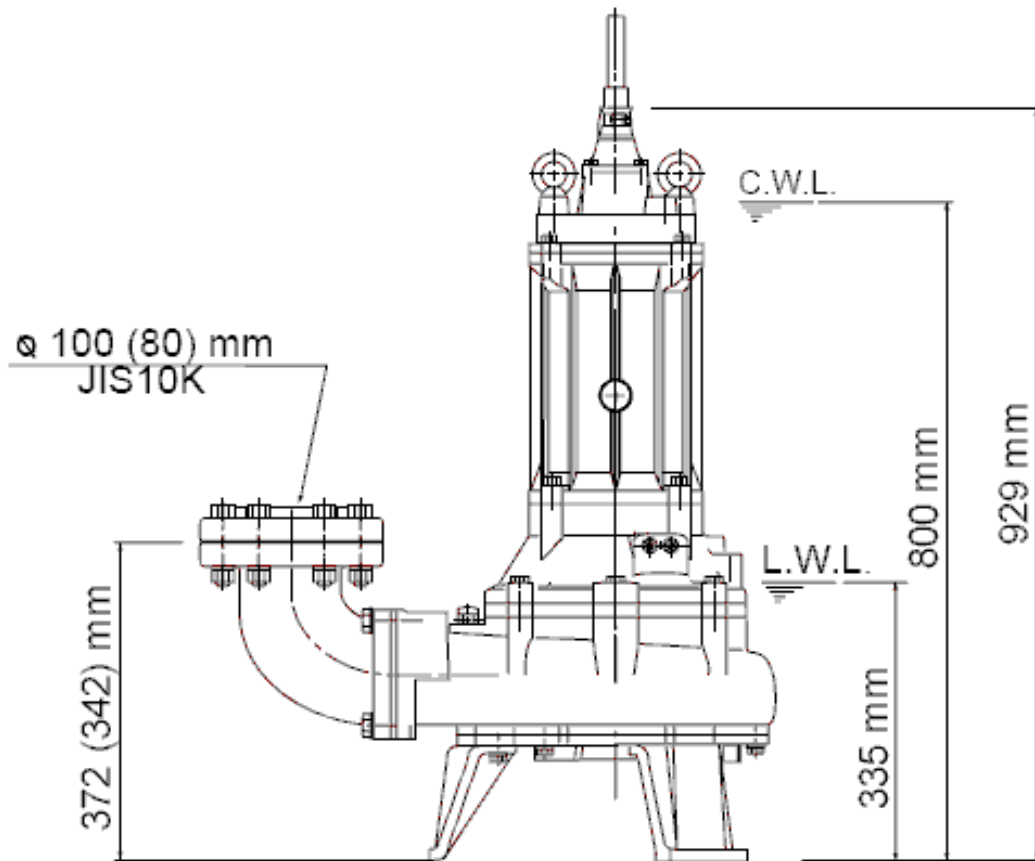
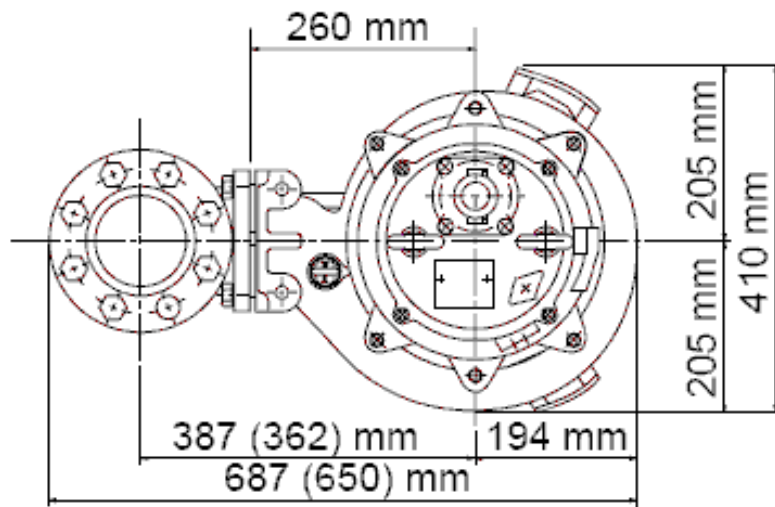

100B47.5-56

CWL: Continuous running water level
LWL: Lowest running water level

Sectional drawing 100B47.5-56

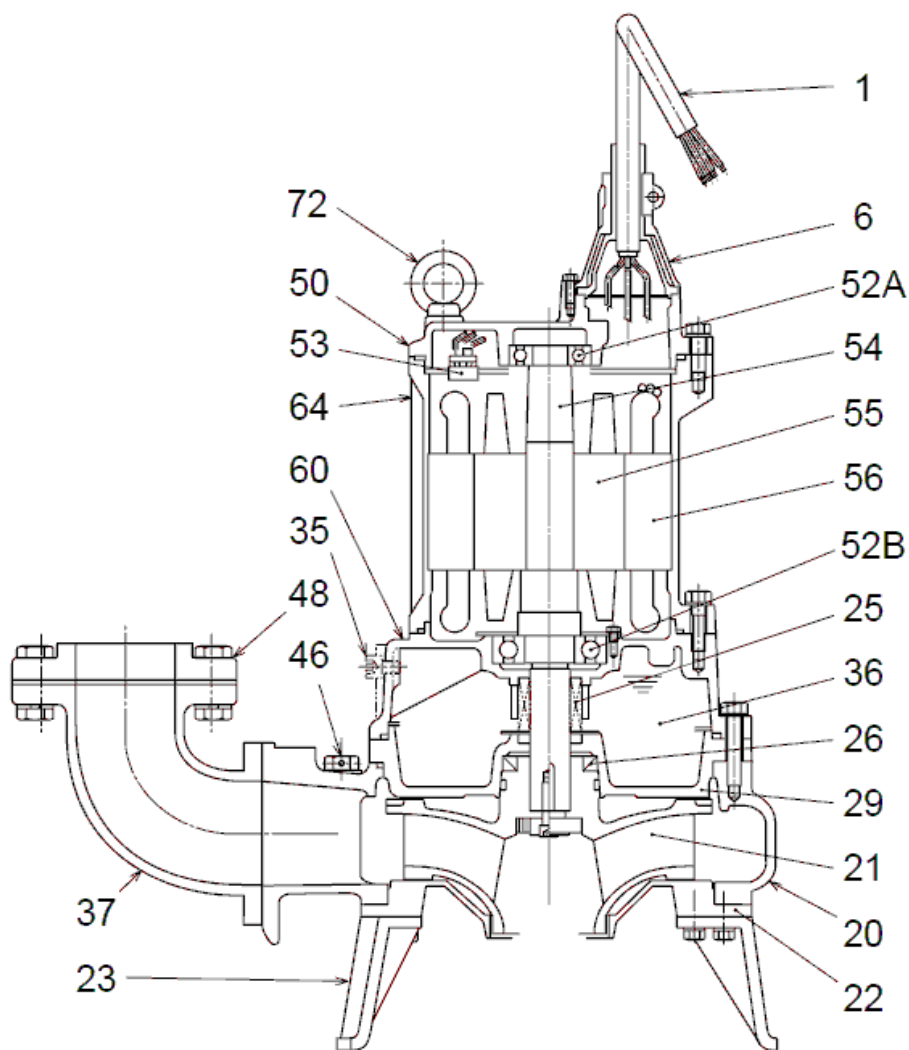

100B47.5-56

No.	Description	Remark	No.	Description	Remark
1	Cable	NSSHÖU	52B	Lower bearing	6309ZZC3
6	Cable entry	FC200 (EN-GJL-200)	53	Motor Protector 380/400/415V-50Hz	KA314-HRXL00 (H.C)
20	Pump casing	FC200 (EN-GJL-200)	54	Shaft	DIN 1.4000 (EN-X6Cr13)
21	Impeller	FC200 (EN-GJL-200)	55	Rotor	.
22	Suction cover	FC200 (EN-GJL-200)	56	Stator	.
23	Stand (3x)	FCD45 (EN-GJS-450-10)	60	Bearings	FC200 (EN-GJL-200)
25	Mechanical seal	H-35A	64	Motor Frame	FC200 (EN-GJL-200)
26	Oil seal	TC608212	72	Eye screw (2x)	Construction steel SS400
29	Oil casing	FC200 (EN-GJL-200)			
35	Oil screw (2x)	DIN 1.4301 (EN-X5CrNi 18-10)			
36	Lubricant	Turbine oil (ISO VG32)			
37	Discharge bend	FC200 (EN-GJL-200)			
46	Air vent valve	Nylon			
48	Screwed Flange	FC200 (EN-GJL-200)			
50	Motor cover	FC200 (EN-GJL-200)			
52A	Upper bearing	6306ZZC3			